



Benchmarks and Monuments 2004

Established by E. Eaton

Revisions - 02/19/05



BENCHMARKS AND MONUMENTS 2004
ESTABLISHED BY E. EATON

INDEX

<u>Monument #</u>	<u>Location</u>
2004-1	Dunn Place - Inkman Road
2004-2	Agassiz Avenue – Centennial Ave.
2004-3	Beaman Drive – Meadow Drive
2004-4	Oakwood Drive – Caroline Drive
2004-5	Pioneer Ave – Ferne Coombe Pool entrance
2004-6	Pioneer Ave – Evergreen Drive
2004-7	Evergreen Drive – north of Kalyna
2004-8	Bristol Drive – Highway #9
2004-9	MacDonald Rd – York Crescent
2004-10	Pioneer Ave – Park Street
2004-11	Highway #9 – Morrow Road
2004-12	Sheffield Drive – Canterbury Drive
2004-13	Vimy Road – McCullough Road
2004-14	Cheam Lane – Heath Road
2004-15	Vimy Road – McDonald Road
2004-16	Elm Road – across from Logan Manor
2004-17	Morrow Road – Parkwood Drive
2004-18	Parkwood Drive – in front of #1560
2004-19	Elm Road – across from #7330
2004-20	Arbutus Drive – Elm Road
2004-21	Morrow Road – Logan Road
2004-22	Industrial Way – 18m from Morrow Road
2004-23	Lougheed Hwy (Mt. Woodside) – 90m W. of #2721
2004-24	Lougheed Hwy (Mt. Woodside) – driveway to café/motel
2004-25	Kilby Road – Mill Road
2004-26	Lougheed Hwy – Rest area (between Seabird and Ruby Creek)
2004-27	Lougheed Hwy – 0.3 km SW of Ruby Creek Bridge (gravel rd)
2004-28	Lougheed Hwy – Wahleach Road
2004-29	Seabird Island Road – Kamp Road
2004-30	Seabird Island Road – across from Peters Road junction
2004-31	Seabird Island Road – across from bridge over Maria Slough
2004-32	Lougheed Hwy – Chowat Road
2004-33	McCartney Road – Scott Road
2004-34	Morrow Road – Pixley Road
2004-35	Rockwell Drive – 10m north of breakwater
2004-36	Rockwell Drive – Pirates Lane
2004-37	Rockwell Drive – Bear Mountain Forestry Road
2004-38	Agassiz Slough – NE side of dyke
BMI-543	Rockwell Drive #7508 – SW corner of pump house

DISTRICT OF KENT SURVEY CONTROL MONUMENT DATA SHEET

PROJECT: 2004 Mapping Program

MONUMENT No.

2004-1

ESTABLISHED BY:

E. Eaton, BCLS

DATE:

DESCRIPTION:

Brass cap in sidewalk at northeast corner of Dunn Place and Inkman Road

COORDINATES: (UTM Zone 10 – NAD 83)

Northing

5454945.971

Easting

589659.109

Combined Scale Factor

0.99969603

ELEVATION: 17.342 metres

Elevation derived from Monument: 1371J

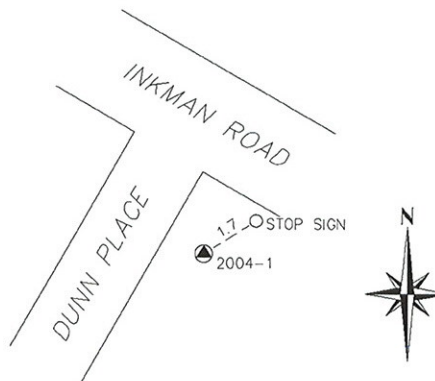

DISTRICT OF KENT SURVEY CONTROL MONUMENT DATA SHEET

PROJECT: 2004 Mapping Program

MONUMENT No.

2004-2

ESTABLISHED BY:

E. Eaton, BCLS

DATE:

DESCRIPTION:

Brass cap in sidewalk on east side of Agassiz Avenue @ intersection with Centennial Avenue.

COORDINATES: (UTM Zone 10 – NAD 83)

Northing

5454628.971

Easting

589425.088

Combined Scale Factor

0.99969557

ELEVATION: 17.049 metres

Elevation derived from Monument: 1371J

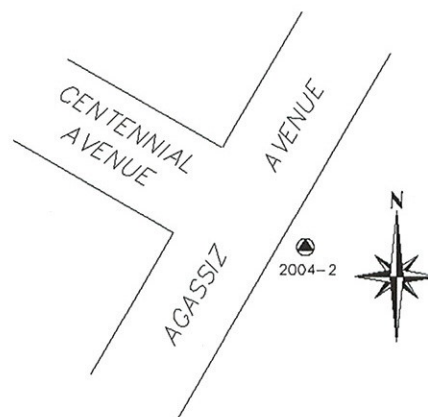

DISTRICT OF KENT SURVEY CONTROL MONUMENT DATA SHEET

PROJECT: 2004 Mapping Program

MONUMENT No.

2004-3

ESTABLISHED BY:

E. Eaton, BCLS

DATE:

DESCRIPTION:

Brass cap in sidewalk @ northeast corner of Beaman Drive and Meadow Drive. Monument is approximately 12 metres north of the centerline of Meadow Drive.

COORDINATES: (UTM Zone 10 – NAD 83)

Northing

5454472.724

Easting

589158.526

Combined Scale Factor

0.99969505

ELEVATION: 16.613 metres

Elevation derived from Monument: 1371J

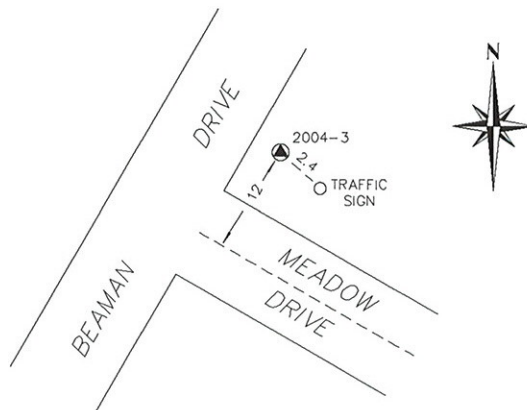

DISTRICT OF KENT SURVEY CONTROL MONUMENT DATA SHEET

PROJECT: 2004 Mapping Program

MONUMENT No.

2004-4

ESTABLISHED BY:

E. Eaton, BCLS

DATE:

DESCRIPTION:

Brass cap in sidewalk @ southwest side of Oakwood Drive. Monument is approximately 10 metres southeast of the intersection of the centerlines of Oakwood Drive and Caroline Drive.

COORDINATES: (UTM Zone 10 – NAD 83)

Northing

5454469.978

Easting

589414.047

Combined Scale Factor

0.99969557

ELEVATION: 16.683 metres

Elevation derived from Monument: 1371J

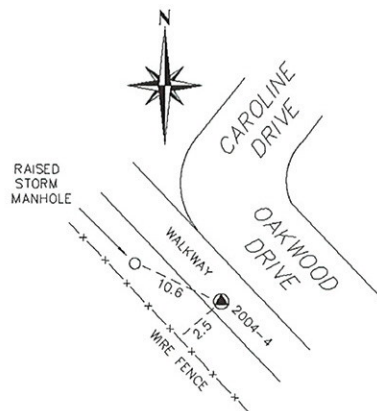

DISTRICT OF KENT SURVEY CONTROL MONUMENT DATA SHEET

PROJECT: 2004 Mapping Program

MONUMENT No.

2004-5

ESTABLISHED BY:

E. Eaton, BCLS

DATE:

DESCRIPTION:

Brass cap in sidewalk on south side of Pioneer Avenue @ driveway into parking lot for pool & Agricultural Hall.

COORDINATES: (UTM Zone 10 – NAD 83)

Northing

5454836.603

Easting

589409.506

Combined Scale Factor

0.99969551

ELEVATION: 17.193 metres

Elevation derived from Monument: 1371J

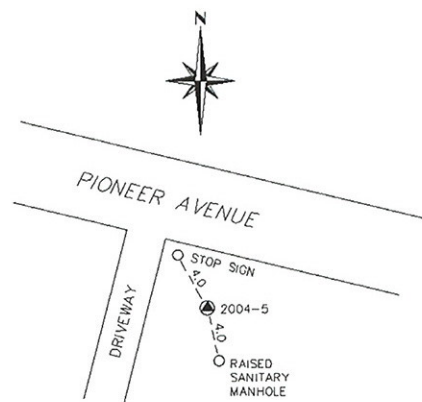

DISTRICT OF KENT SURVEY CONTROL MONUMENT DATA SHEET

PROJECT: 2004 Mapping Program

MONUMENT No.

2004-6

ESTABLISHED BY:

E. Eaton, BCLS

DATE:

DESCRIPTION:

Brass cap in sidewalk @ northeast corner of Pioneer Avenue & Evergreen Drive.

COORDINATES: (UTM Zone 10 – NAD 83)

Northing

5454767.497

Easting

589844.12

Combined Scale Factor

0.99969632

ELEVATION: 18.097 metres

Elevation derived from Monument: 1371J

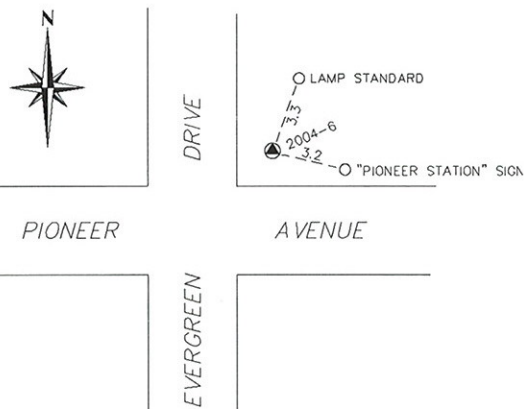

DISTRICT OF KENT SURVEY CONTROL MONUMENT DATA SHEET

PROJECT: 2004 Mapping Program

MONUMENT No.

2004-7

ESTABLISHED BY:

E. Eaton, BCLS

DATE:

DESCRIPTION:

Brass cap in sidewalk on east side of Evergreen Drive. Monument is approximately 40 metres north of the intersection of the centerlines of Evergreen Drive & Kalyna Drive and is just north of 1706 Evergreen Drive.

COORDINATES: (UTM Zone 10 – NAD 83)

Northing

5454429.182

Easting

589810.71

Combined Scale Factor

0.99969629

ELEVATION: 17.836 metres

Elevation derived from Monument: 1371J

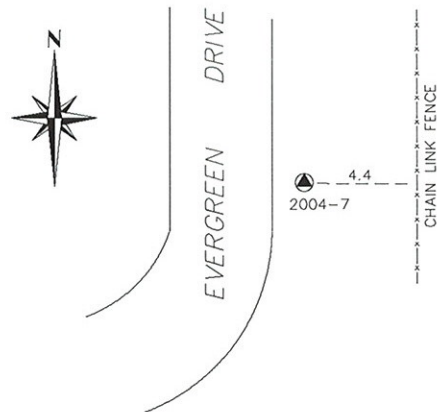

DISTRICT OF KENT SURVEY CONTROL MONUMENT DATA SHEET

PROJECT: 2004 Mapping Program

MONUMENT No.

2004-8

ESTABLISHED BY:

E. Eaton, BCLS

DATE:

DESCRIPTION:

Brass cap in sidewalk @ northeast corner of Highway #9 & Bristol Drive. Monument is approximately 21 metres north of the centerline of Bristol Drive.

COORDINATES: (UTM Zone 10 – NAD 83)

Northing

5454137.498

Easting

589925.052

Combined Scale Factor

0.99969662

ELEVATION: 17.306 metres

Elevation derived from Monument: 14B

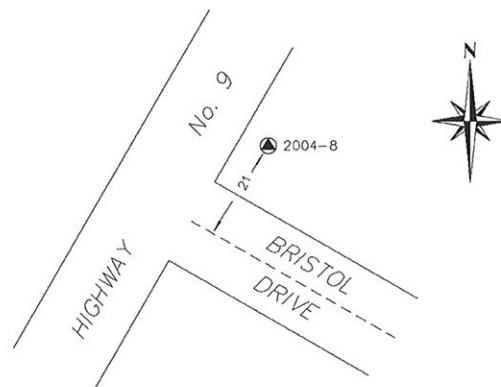

DISTRICT OF KENT SURVEY CONTROL MONUMENT DATA SHEET

PROJECT: 2004 Mapping Program

MONUMENT No.

2004-9

ESTABLISHED BY:

E. Eaton, BCLS

DATE:

DESCRIPTION:

Brass cap in sidewalk @ northeast corner of MacDonald Road & York Crescent.

COORDINATES: (UTM Zone 10 – NAD 83)

Northing

5453933.682

Easting

589884.911

Combined Scale Factor

0.99969639

ELEVATION: 18.238 metres

Elevation derived from Monument: 14B

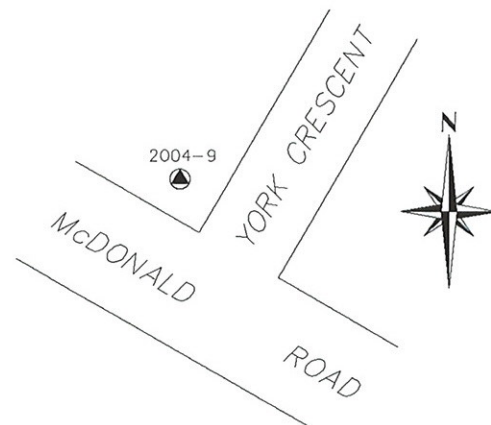

DISTRICT OF KENT SURVEY CONTROL MONUMENT DATA SHEET

PROJECT: 2004 Mapping Program

MONUMENT No.

2004-10

ESTABLISHED BY:

E. Eaton, BCLS

DATE:

DESCRIPTION:

Brass cap in sidewalk @ northwest corner of Pioneer Avenue & Park Street.

COORDINATES: (UTM Zone 10 – NAD 83)

Northing

5454740.681

Easting

590137.61

Combined Scale Factor

0.99969691

ELEVATION: 18.46 metres

Elevation derived from Monument: 1371J

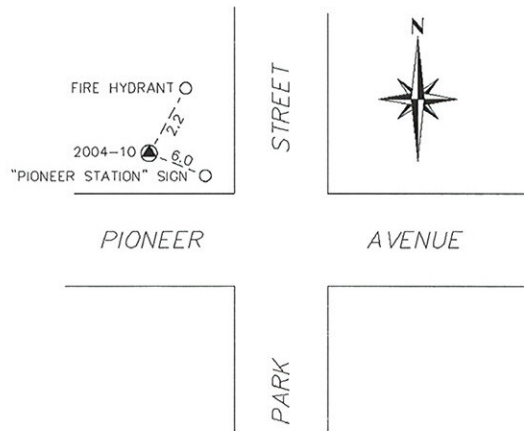

DISTRICT OF KENT SURVEY CONTROL MONUMENT DATA SHEET

PROJECT: 2004 Mapping Program

MONUMENT No.

2004-11

ESTABLISHED BY:

E. Eaton, BCLS

DATE:

DESCRIPTION:

Brass cap in sidewalk @ northwest corner of Highway #9 and Morrow Road.

COORDINATES: (UTM Zone 10 – NAD 83)

Northing

5454416.821

Easting

590160.214

Combined Scale Factor

0.99969707

ELEVATION: 17.763 metres

Elevation derived from Monument: 1371J

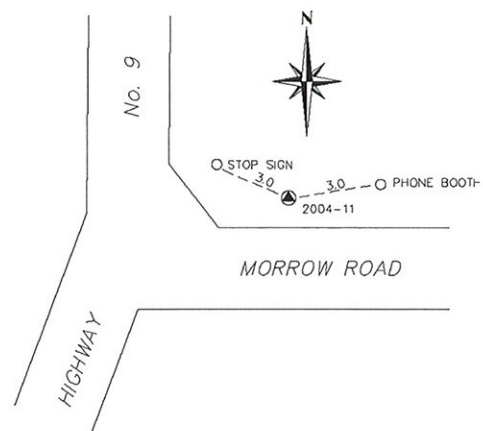

DISTRICT OF KENT SURVEY CONTROL MONUMENT DATA SHEET

PROJECT: 2004 Mapping Program

MONUMENT No.

2004-12

ESTABLISHED BY:

E. Eaton, BCLS

DATE:

DESCRIPTION:

Brass cap in sidewalk @ southwest corner of Sheffield Drive & Canterbury Drive.

COORDINATES: (UTM Zone 10 – NAD 83)

Northing

5454178.049

Easting

590100.762

Combined Scale Factor

0.99969691

ELEVATION: 18.03 metres

Elevation derived from Monument: 14B



DRIVE

SHEFFIELD
DRIVE

2004-12 

CANTERBURY
DRIVE

DISTRICT OF KENT SURVEY CONTROL MONUMENT DATA SHEET

PROJECT: 2004 Mapping Program

MONUMENT No.

2004-13

ESTABLISHED BY:

E. Eaton, BCLS

DATE:

DESCRIPTION:

Brass cap in sidewalk @ northeast corner of Vimy Road and McCullough road. Monument is in front of house #1610 Vimy Road.

COORDINATES: (UTM Zone 10 – NAD 83)

Northing

5454189.426

Easting

590220.483

Combined Scale Factor

0.99969716

ELEVATION: 18.031 metres

Elevation derived from Monument: 1371J

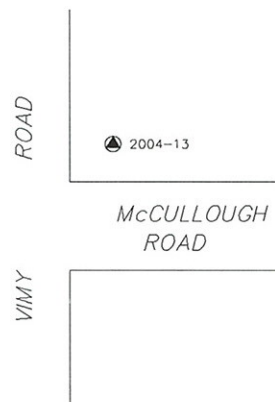

DISTRICT OF KENT SURVEY CONTROL MONUMENT DATA SHEET

PROJECT: 2004 Mapping Program

MONUMENT No.

2004-14

ESTABLISHED BY:

E. Eaton, BCLS

DATE:

DESCRIPTION:

Brass cap in sidewalk on southwest corner of Cheam Lane and Heath Road. Monument is approximately 18 metres southwest of the intersection of the centerlines.

COORDINATES: (UTM Zone 10 – NAD 83)

Northing

5454644.13

Easting

590362.566

Combined Scale Factor

0.99969741

ELEVATION: 18.483 metres

Elevation derived from Monument: 1371J

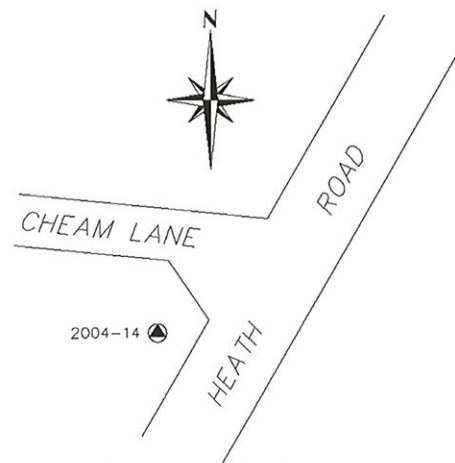

DISTRICT OF KENT SURVEY CONTROL MONUMENT DATA SHEET

PROJECT: 2004 Mapping Program

MONUMENT No.

2004-15

ESTABLISHED BY:

E. Eaton, BCLS

DATE:

DESCRIPTION:

Brass cap in sidewalk @ northwest corner of Vimy Road and McDonald Road.

COORDINATES: (UTM Zone 10 – NAD 83)

Northing

5453785.278

Easting

590200.979

Combined Scale Factor

0.99969715

ELEVATION: 17.866 metres

Elevation derived from Monument: 14B

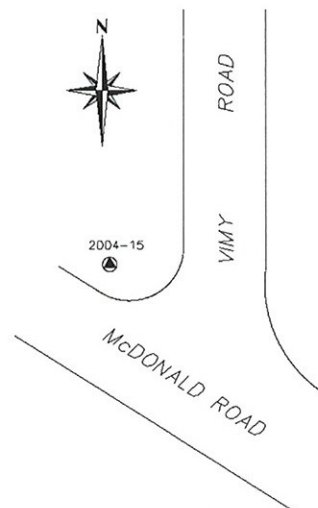

DISTRICT OF KENT SURVEY CONTROL MONUMENT DATA SHEET

PROJECT: 2004 Mapping Program

MONUMENT No.

2004-16

ESTABLISHED BY:

E. Eaton, BCLS

DATE:

DESCRIPTION:

Brass cap in sidewalk on north side of Elm Road in front of #7279. Monument is across the street from the Logan Manor.

COORDINATES: (UTM Zone 10 – NAD 83)

Northing

5453934.888

Easting

590390.807

Combined Scale Factor

0.99969755

ELEVATION: 17.959 metres

Elevation derived from Monument: 14B

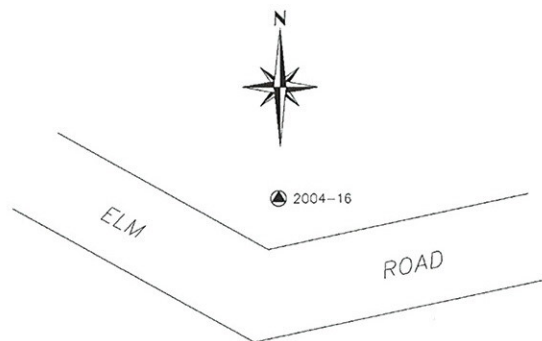

DISTRICT OF KENT SURVEY CONTROL MONUMENT DATA SHEET

PROJECT: 2004 Mapping Program

MONUMENT No.
2004-17

ESTABLISHED BY:
E. Eaton, BCLS

DATE:

DESCRIPTION:

Brass cap in sidewalk @ southeast corner of Morrow Road and Parkwood Drive.

COORDINATES: (UTM Zone 10 – NAD 83)

Northing
5454399.82

Easting
590606.242

Combined Scale Factor
0.9996979

ELEVATION: 18.752 metres

Elevation derived from Monument: 1371J

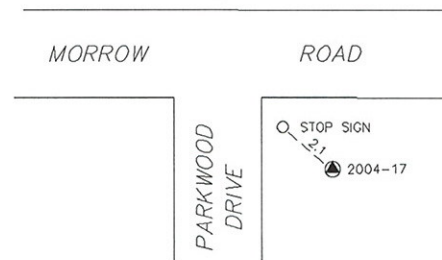

DISTRICT OF KENT SURVEY CONTROL MONUMENT DATA SHEET

PROJECT: 2004 Mapping Program

MONUMENT No.
2004-18

ESTABLISHED BY:
E. Eaton, BCLS

DATE:

DESCRIPTION:

Brass cap in sidewalk on east side of Parkwood Drive in front of house #1560.

COORDINATES: (UTM Zone 10 – NAD 83)

Northing
5454075.738

Easting
590611.009

Combined Scale Factor
0.99969794

ELEVATION: 18.592 metres

Elevation derived from Monument: 1371J



PARKWOOD
DRIVE

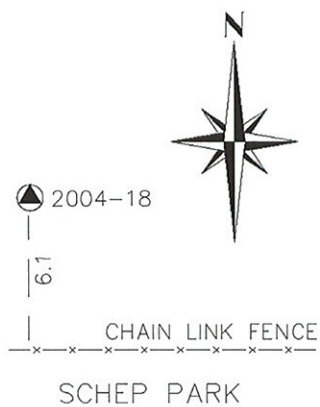

DISTRICT OF KENT SURVEY CONTROL MONUMENT DATA SHEET

PROJECT: 2004 Mapping Program

MONUMENT No.

2004-19

ESTABLISHED BY:

E. Eaton, BCLS

DATE:

DESCRIPTION:

Brass cap in sidewalk on north side of Elm Road directly across from 7330 Elmwood Place

COORDINATES: (UTM Zone 10 – NAD 83)

Northing

5453953.931

Easting

590625.249

Combined Scale Factor

0.99969803

ELEVATION: 18.257 metres

Elevation derived from Monument: 14B

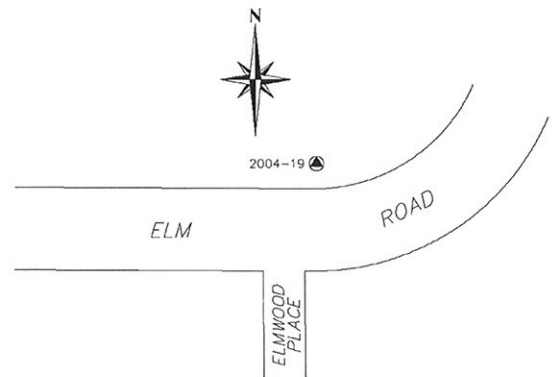

DISTRICT OF KENT SURVEY CONTROL MONUMENT DATA SHEET

PROJECT: 2004 Mapping Program

MONUMENT No.

2004-20

ESTABLISHED BY:

E. Eaton, BCLS

DATE:

DESCRIPTION:

Brass cap in sidewalk @ southwest corner of Arbutus Drive and Elm Road. Monument is approximately 1m north of hydro vault.

COORDINATES: (UTM Zone 10 – NAD 83)

Northing

5454098.407

Easting

590929.14

Combined Scale Factor

0.9996987

ELEVATION: 18.272 metres

Elevation derived from Monument: 14B

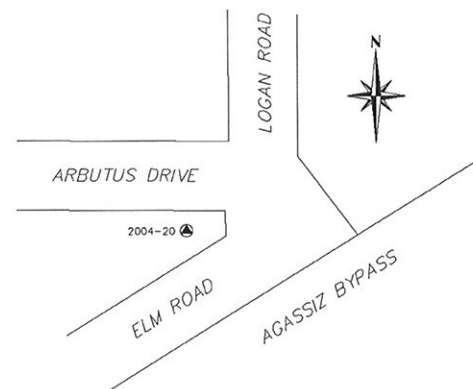

DISTRICT OF KENT SURVEY CONTROL MONUMENT DATA SHEET

PROJECT: 2004 Mapping Program

MONUMENT No.
2004-21

ESTABLISHED BY:
E. Eaton, BCLS

DATE:

DESCRIPTION:

Brass cap in sidewalk @ southwest corner of Morrow Road and Logan Road.

COORDINATES: (UTM Zone 10 – NAD 83)

Northing
5454406.125

Easting
590918.827

Combined Scale Factor
0.9996985

ELEVATION: 19.394 metres

Elevation derived from Monument: 1371J

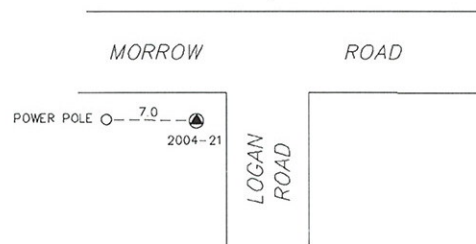

DISTRICT OF KENT SURVEY CONTROL MONUMENT DATA SHEET

PROJECT: 2004 Mapping Program

MONUMENT No.

2004-22

ESTABLISHED BY:

E. Eaton, BCLS

DATE:

DESCRIPTION:

Brass cap in sidewalk on east side of Industrial Way. Monument is approximately 18m north 4th lamp standard from Morrow Road and 15m south of the end of the sidewalk.

COORDINATES: (UTM Zone 10 – NAD 83)

Northing

5454566.936

Easting

591134.222

Combined Scale Factor

0.9996991

ELEVATION: 18.594 metres

Elevation derived from Monument: 1371J



INDUSTRIAL
WAY

● 2004-22

— 18 —

○ LAMP STANDARD



DISTRICT OF KENT SURVEY CONTROL MONUMENT DATA SHEET

PROJECT: 2004 Mapping Program

MONUMENT No.
2004-23

ESTABLISHED BY:
E. Eaton, BCLS

DATE:

DESCRIPTION:

Brass cap in concrete pier on north shoulder of Lougheed Highway on Mount Woodside. Monument is approximately 0.3 km west of Dec Creek spring and approximately 90m west of driveway leading to 2721 Lougheed Highway.

COORDINATES: (UTM Zone 10 – NAD 83)

Northing
5453745.717

Easting
581101.593

Combined Scale Factor
0.99966394

ELEVATION: 107.87 metres

Elevation derived from Monument: 66C041

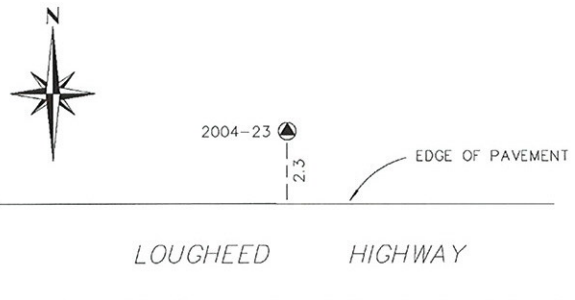

DISTRICT OF KENT SURVEY CONTROL MONUMENT DATA SHEET

PROJECT: 2004 Mapping Program

MONUMENT No.

2004-24

ESTABLISHED BY:

E. Eaton, BCLS

DATE:

DESCRIPTION:

Brass cap in concrete pier on southwest shoulder of Lougheed Highway on Mount Woodside. Monument is at driveway to café/motel.

COORDINATES: (UTM Zone 10 – NAD 83)

Northing

5453905.225

Easting

580054.584

Combined Scale Factor

0.99966504

ELEVATION: 87.486 metres

Elevation derived from Monument: 66C041

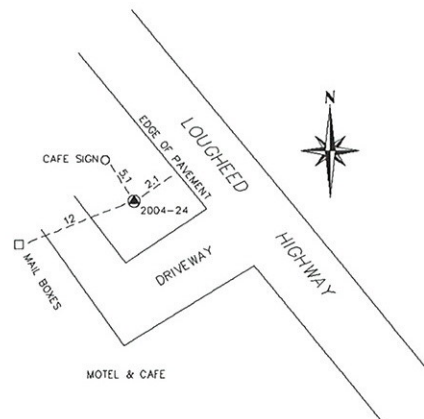

DISTRICT OF KENT SURVEY CONTROL MONUMENT DATA SHEET

PROJECT: 2004 Mapping Program

MONUMENT No.

2004-25

ESTABLISHED BY:

E. Eaton, BCLS

DATE:

DESCRIPTION:

Brass cap in concrete pier on south shoulder of Kilby Road @ intersection with Mill Road.

COORDINATES: (UTM Zone 10 – NAD 83)

Northing

5454082.313

Easting

577061.546

Combined Scale Factor

0.99967119

ELEVATION: 11.295 metres

Elevation derived from Monument: 9B

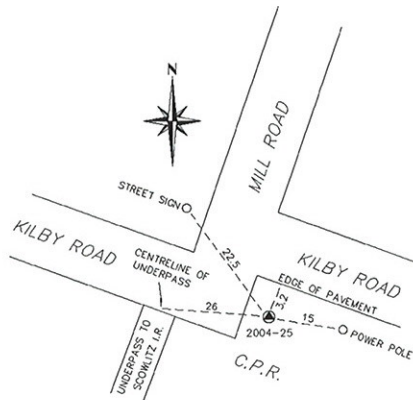

DISTRICT OF KENT SURVEY CONTROL MONUMENT DATA SHEET

PROJECT: 2004 Mapping Program

MONUMENT No.
2004-26

ESTABLISHED BY:
E. Eaton, BCLS

DATE:

DESCRIPTION:

Brass cap in concrete pier on western shoulder of Lougheed highway @ southwest entrance to rest area. Rest area is between Seabird Island and Ruby Creek and is directly across the highway from the Fraser River debris trap.

COORDINATES: (UTM Zone 10 – NAD 83)

Northing
5464954.986

Easting
598960.345

Combined Scale Factor
0.99971562

ELEVATION: 29.159 metres

Elevation derived from Monument: 66C099

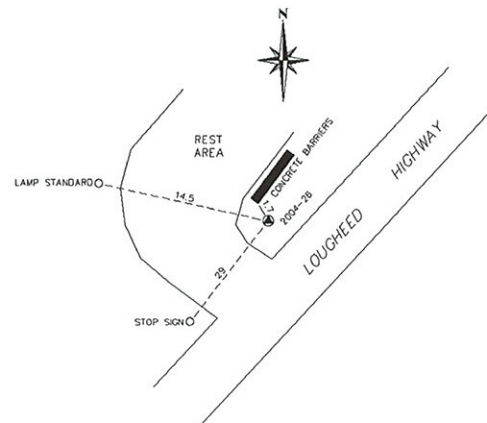

DISTRICT OF KENT SURVEY CONTROL MONUMENT DATA SHEET

PROJECT: 2004 Mapping Program

MONUMENT No.

2004-27

ESTABLISHED BY:

E. Eaton, BCLS

DATE:

DESCRIPTION:

Brass cap in concrete pier on western shoulder of Lougheed highway @ intersection with gravel road. Monument is approximately 0.3 km southwest of Ruby Creek Bridge.

COORDINATES: (UTM Zone 10 – NAD 83)

Northing

5467582.637

Easting

600719.205

Combined Scale Factor

0.999719.205

ELEVATION: 31.453 metres

Elevation derived from Monument: 310J

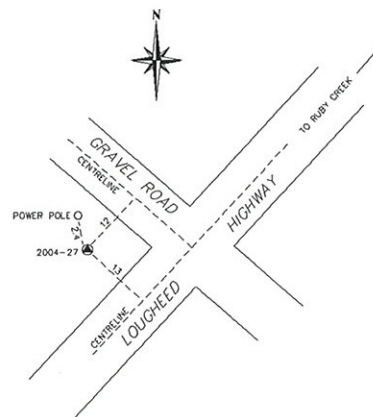

DISTRICT OF KENT SURVEY CONTROL MONUMENT DATA SHEET

PROJECT: 2004 Mapping Program

MONUMENT No.

2004-28

ESTABLISHED BY:

E. Eaton, BCLS

DATE:

DESCRIPTION:

Brass cap in concrete pier @ northwest corner of Wahleach Road & Lougheed Highway.

COORDINATES: (UTM Zone 10 – NAD 83)

Northing

5461091.414

Easting

595362.855

Combined Scale Factor

0.99970787

ELEVATION: 24.201 metres

Elevation derived from Monument: 93HAW005

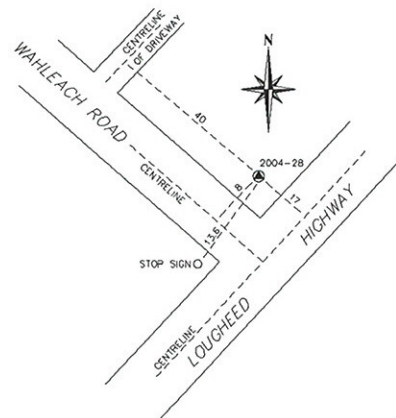

DISTRICT OF KENT SURVEY CONTROL MONUMENT DATA SHEET

PROJECT: 2004 Mapping Program

MONUMENT No.

2004-29

ESTABLISHED BY:

E. Eaton, BCLS

DATE:

DESCRIPTION:

Brass cap in concrete pier @ northwest corner Kamp Road & Seabird Island Road.

COORDINATES: (UTM Zone 10 – NAD 83)

Northing

5461593.651

Easting

593949.327

Combined Scale Factor

0.99970509

ELEVATION: 21.023 metres

Elevation derived from Monument: 93HAW005

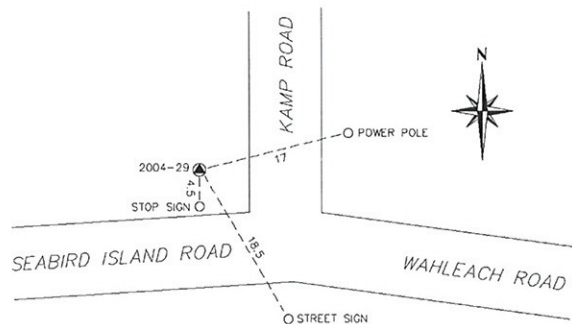

DISTRICT OF KENT SURVEY CONTROL MONUMENT DATA SHEET

PROJECT: 2004 Mapping Program

MONUMENT No.

2004-30

ESTABLISHED BY:

E. Eaton, BCLS

DATE:

DESCRIPTION:

Brass cap in concrete pier on western shoulder of Seabird Island Road. Monument is on a production of the centerline of Peters Road.

COORDINATES: (UTM Zone 10 – NAD 83)

Northing

5460041.585

Easting

593062.905

Combined Scale Factor

0.99970304

ELEVATION: 21.115 metres

Elevation derived from Monument: 93HAW005

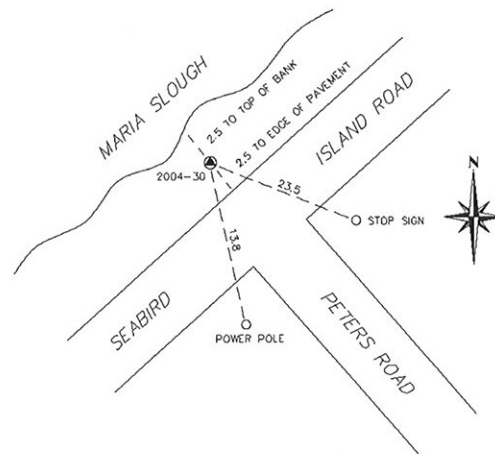

DISTRICT OF KENT SURVEY CONTROL MONUMENT DATA SHEET

PROJECT: 2004 Mapping Program

MONUMENT No.

2004-31

ESTABLISHED BY:

E. Eaton, BCLS

DATE:

DESCRIPTION:

Brass cap in concrete pier on eastern shoulder of Seabird Island Road across from bridge over Maria Slough.

COORDINATES: (UTM Zone 10 – NAD 83)

Northing

5458500.861

Easting

592362.758

Combined Scale Factor

0.99970154

ELEVATION: 20.626 metres

Elevation derived from Monument: 93HAW005

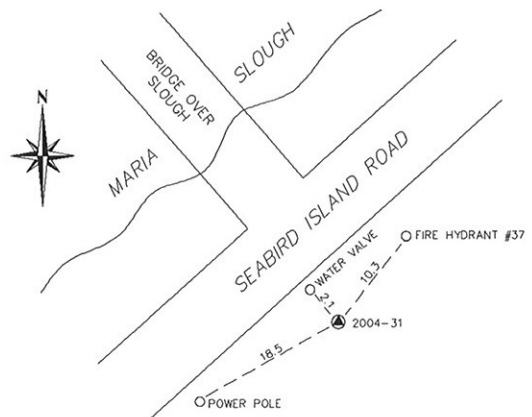

DISTRICT OF KENT SURVEY CONTROL MONUMENT DATA SHEET

PROJECT: 2004 Mapping Program

MONUMENT No.
2004-32

ESTABLISHED BY:
E. Eaton, BCLS

DATE:

DESCRIPTION:

Brass cap in concrete pier on western shoulder of Lougheed Highway @ intersection with Chowat Road.

COORDINATES: (UTM Zone 10 – NAD 83)

Northing
5458786.534

Easting
593947.404

Combined Scale Factor
0.99970488

ELEVATION: 22.418 metres

Elevation derived from Monument: 93HAW005

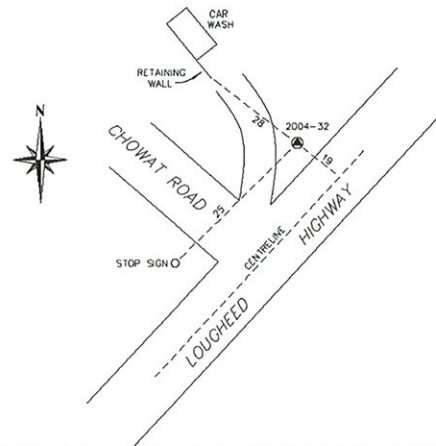

DISTRICT OF KENT SURVEY CONTROL MONUMENT DATA SHEET

PROJECT: 2004 Mapping Program

MONUMENT No.

2004-33

ESTABLISHED BY:

E. Eaton, BCLS

DATE:

DESCRIPTION:

Brass cap in concrete pier on south shoulder of McCartney Road @ intersection with Scott Road.

COORDINATES: (UTM Zone 10 – NAD 83)

Northing

5454542.041

Easting

591612.706

Combined Scale Factor

0.99969998

ELEVATION: 19.812 metres

Elevation derived from Monument: 93HAW005

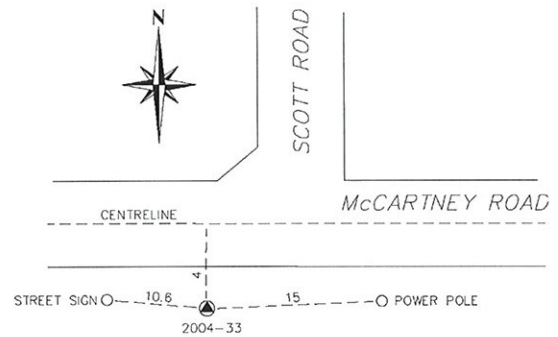

DISTRICT OF KENT SURVEY CONTROL MONUMENT DATA SHEET

PROJECT: 2004 Mapping Program

MONUMENT No.

2004-34

ESTABLISHED BY:

E. Eaton, BCLS

DATE:

DESCRIPTION:

Brass cap in concrete pier @ northeast corner of Morrow Road and Pixley Road.

COORDINATES: (UTM Zone 10 – NAD 83)

Northing

5454428.58

Easting

591217.989

Combined Scale Factor

0.99969922

ELEVATION: 19.058 metres

Elevation derived from Monument: 1371J

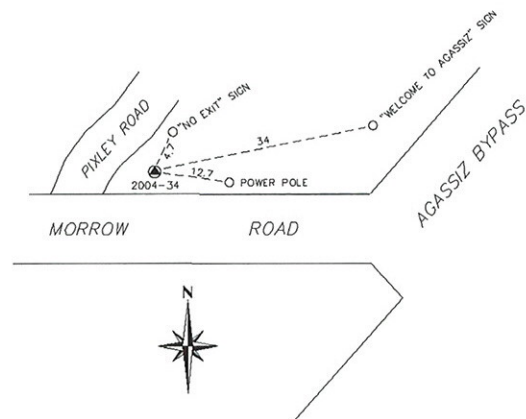

DISTRICT OF KENT SURVEY CONTROL MONUMENT DATA SHEET

PROJECT: 2004 Mapping Program

MONUMENT No.
2004-35

ESTABLISHED BY:
E. Eaton, BCLS

DATE: revised Oct 2005

DESCRIPTION:

Brass cap in concrete pier on west shoulder of Rockwell Drive at the breakwater. Monument is 10 metres north of the production of the centerline of the breakwater.

COORDINATES: (UTM Zone 10 – NAD 83)

Northing
5462868.003

Easting
589209.405

Combined Scale Factor
0.9996957

ELEVATION: 12.88 metres

Elevation derived from Monument: 77C626

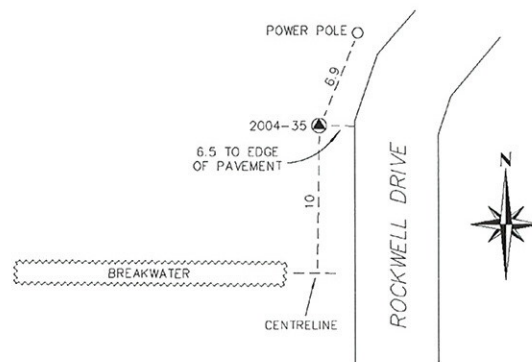

DISTRICT OF KENT SURVEY CONTROL MONUMENT DATA SHEET

PROJECT: 2004 Mapping Program

MONUMENT No.
2004-36

ESTABLISHED BY:
E. Eaton, BCLS

DATE: revised October 2005

DESCRIPTION:

Brass cap in concrete pier @ southwest corner of Rockwell Drive and Pirates Lane

COORDINATES: (UTM Zone 10 – NAD 83)

Northing
5463636.099

Easting
590284.939

Combined Scale Factor
0.9996944

ELEVATION: 18.318 metres

Elevation derived from Monument: 77C626

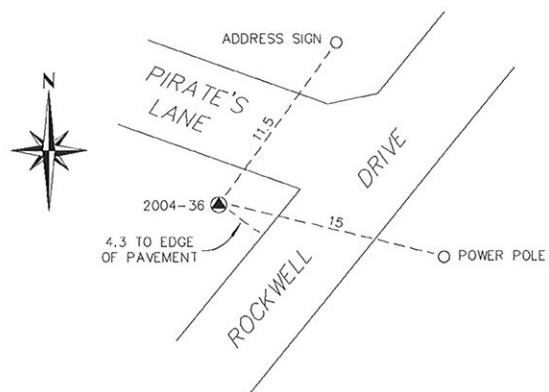

DISTRICT OF KENT SURVEY CONTROL MONUMENT DATA SHEET

PROJECT: 2004 Mapping Program

MONUMENT No.
2004-37

ESTABLISHED BY:
E. Eaton, BCLS

DATE: revised October 2005

DESCRIPTION:

Brass cap in concrete pier on east side of Rockwell Drive @ the Bear Mountain Forestry Road. Monument is approximately 11 metres north of the centerline of Bear Mountain Forestry Road and is in front of house #7190 Rockwell Drive.

COORDINATES: (UTM Zone 10 – NAD 83)

Northing
5465204.32

Easting
590732.195

Combined Scale Factor
0.99969315

ELEVATION: 50.57 metres

Elevation derived from Monument: 77C626

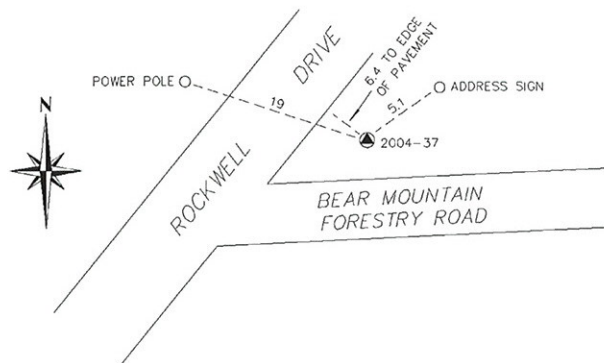

DISTRICT OF KENT SURVEY CONTROL MONUMENT DATA SHEET

PROJECT: 2004 Mapping Program

MONUMENT No.

2004-38

ESTABLISHED BY:

E. Eaton, BCLS

DATE:

DESCRIPTION:

Brass cap in concrete pier on northeast side of dyke between water level gauges on the Agassiz Slough.

COORDINATES: (UTM Zone 10 – NAD 83)

Northing

5452661.035

Easting

588845.243

Combined Scale Factor

0.99969408

ELEVATION: 18.456 metres

Elevation derived from Monument: 93HAW003

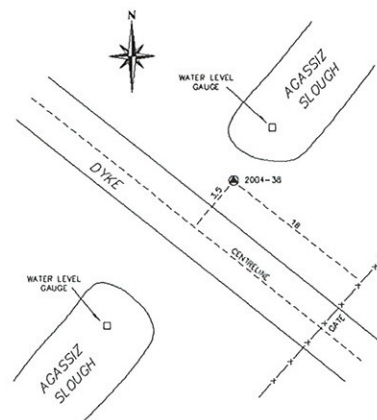

DISTRICT OF KENT SURVEY CONTROL MONUMENT DATA SHEET

PROJECT: 2004 Mapping Program

MONUMENT No.
BMI-543

ESTABLISHED BY:
E. Eaton, BCLS

DATE: revised October 2005

DESCRIPTION:

Brass cap in concrete at southwest corner of pump house compound @ 7508 Rockwell Drive.

COORDINATES: (UTM Zone 10 – NAD 83)

Northing
5466131.797

Easting
591199.022

Combined Scale Factor
0.99969743

ELEVATION: 29.813 metres

Elevation derived from Monument: 77C626

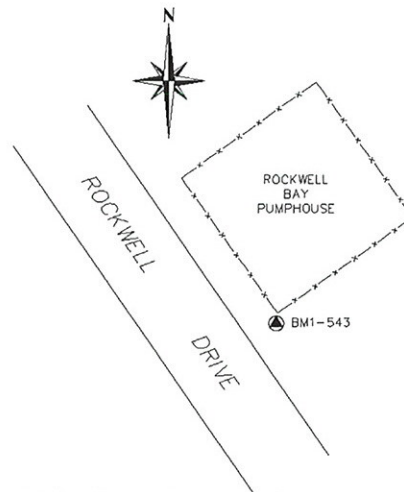

Revisions - Oct 19/05

COORDINATES ARE UTM

NUMBER	NORTHING	EASTING	ELEVATION	DESCRIPTION	COMBINED SCALE FACTOR	ELEVATION DERIVED FROM	NOTES
2004-1	5454945.971	589659.109	17.342	MON	0.99969603	1371J	
2004-2	5454628.187	589425.088	17.049	MON	0.99969557	1371J	
2004-3	5454472.724	589158.526	16.613	MON	0.99969505	1371J	
2004-4	5454469.978	589414.047	16.83	MON	0.99969557	1371J	
2004-5	5454836.603	589409.506	17.193	MON	0.99969551	1371J	
2004-6	5454767.497	589844.12	18.097	MON	0.99969632	1371J	
2004-7	5454429.182	589810.71	17.836	MON	0.99969629	1371J	
2004-8	5454137.498	589925.052	17.316	MON	0.99969662	14B	
2004-9	5453933.682	589884.911	18.238	MON	0.99969639	14B	
2004-10	5454740.681	590137.61	18.46	MON	0.99969691	1371J	
2004-11	5454416.821	590160.214	17.763	MON	0.99969707	1371J	
2004-12	5454178.049	590100.762	18.03	MON	0.99969691	14B	
2004-13	5454189.426	590220.483	18.031	MON	0.99969716	1371J	
2004-14	5454644.13	590362.566	18.483	MON	0.99969741	1371J	
2004-15	5453785.278	590200.979	17.866	MON	0.99969715	14B	
2004-16	5453934.888	590390.807	17.959	MON	0.99969755	14B	
2004-17	5454399.82	590606.242	18.752	MON	0.9996979	1371J	
2004-18	5454075.738	590611.009	18.592	MON	0.99969794	1371J	
2004-19	5453953.931	590625.249	18.257	MON	0.99969803	14B	
2004-20	5454098.407	590929.14	18.272	MON	0.9996987	14B	
2004-21	5454406.125	590918.827	19.394	MON	0.9996985	1371J	
2004-22	5454566.936	591134.222	18.594	MON	0.9996991	1371J	
2004-23	5453745.717	581101.593	107.87	MON	0.99966394	66C041	
2004-24	5453905.225	580054.584	87.486	MON	0.99966504	66C041	
2004-25	5454082.313	577061.546	11.295	MON	0.99967119	9B	
2004-26	5464954.986	598960.345	29.159	MON	0.99971562	66C099	
2004-27	5467582.637	600719.205	31.453	MON	0.99971955	310J	
2004-28	5461091.414	595362.855	24.201	MON	0.99970787	93HAW005	
2004-29	5461593.651	593949.327	21.023	MON	0.99970509	93HAW005	
2004-30	5460041.585	593062.905	21.115	MON	0.99970304	93HAW005	
2004-31	5458500.861	592362.758	20.626	MON	0.99970154	93HAW005	
2004-32	5458786.534	593947.404	22.418	MON	0.99970488	93HAW005	
2004-33	5454542.041	591612.706	19.812	MON	0.99969998	93HAW005	
2004-34	5454428.58	591217.989	19.058	MON	0.99969922	1371J	
2004-35	5462868.003	589209.405	12.88	MON	0.9996957	77C626	
2004-36	5463636.099	590284.939	18.318	MON	0.9996944	77C626	Approx Scale Factor Only
2004-37	5465204.32	590732.195	50.57	MON	0.99969315	77C626	
2004-38	5452661.035	588845.243	18.456	MON	0.99969408	93HAW003	
BM1-543	5466131.797	591199.022	29.813	MON	0.99969743	77C626	
2D	5456902.941	586599.381	14.906	MON	0.99968979		Previously Published Elevation
2E	5456928.14	587573.58	14.855	MON	0.99969188		Previously Published Elevation
9C	5454864.017	576727.347	10.581	MON	0.99967068		Previously Published Elevation
92HAW-014	5454714.951	588379.259	16.667	MON	0.99969335		Previously Published Elevation
92HAW-015	5453618.858	589040.392	17.752	MON	0.99969462		Previously Published Elevation
92HAW-016	5457282.718	591354.853	20.516	MON	0.99969929		Previously Published Elevation
93HAW-002	5452576.661	588382.744	16.349	MON	0.99969341		Previously Published Elevation
93HAW-003	5452597.719	588410.401	16.305	MON	0.99969347		Previously Published Elevation
93HAW-005	5455747.697	592090.477	21.521	MON	0.99970079		Previously Published Elevation
687	5455717.126	592071.494	21.525	MON	0.99970075		Previously Published Elevation
779	5453548.135	591935.897	18.999	MON	0.99970084		Previously Published Elevation
781	5452588.732	589420.335	17.209	MON	0.99969553		Previously Published Elevation